



Quick Start Guide

For iFusion documentation in other languages and general support information, visit <http://www.thefusionphone.com>

Setting up the iFusion

1. Extend the stand

Swivel the bottom of the stand away from the base of the iFusion until you feel it lock into place.

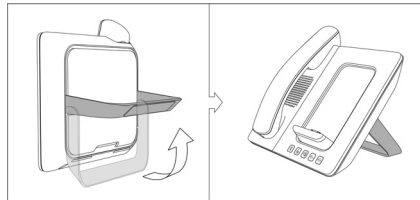

2. Attach the handset

Lift the lower back cover and attach the long end of the handset cord to the handset port in the back of the iFusion. Then attach the short end to the handset. Run the cord through the cable guide so that the iFusion does not wobble on the desk.

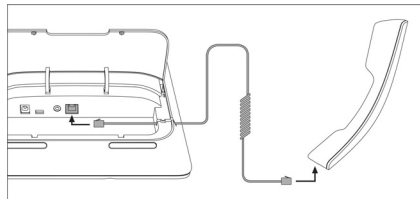

3. Plug it in

Attach the cable from the power supply to the power port in back of the iFusion. Plug the power cord into an outlet. (The iFusion will not work unless the power cord is plugged into a power outlet.)

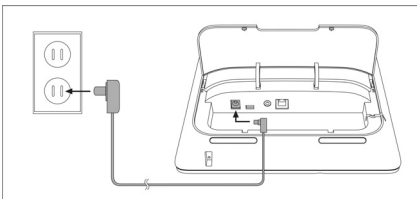

4. Connect external speakers (optional)

You can connect external speakers to the audio jack in the back of the iFusion.

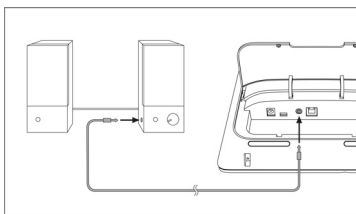

Docking the iPhone

If your iPhone is not in a case, you can put the small cushion (provided) in the bottom of the cradle so that the iPhone sits correctly. To remove the cushion, pull it up by the notch on its right side.

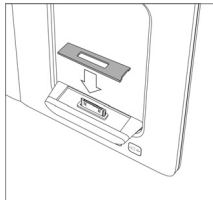

Also, you can apply the large cushion to the back of the cradle, at the top, to reduce vibration noise.

You must pair the iFusion with your iPhone before you can use it.

Charging the iPhone

While the iPhone is docked in the iFusion, it is automatically charging.

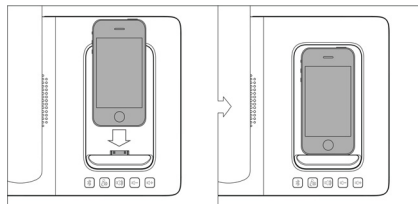



Choosing a Bluetooth Mode

Before you pair your iPhone with the iFusion Station, choose which way you prefer to work.

- **Bluetooth Docked mode (recommended)** – iFusion operates only when you dock the iPhone in the iFusion cradle.

Start this mode by docking the iPhone in the cradle *before* you pair the devices.

When you remove the iPhone from the cradle, the Bluetooth connection between the devices will temporarily disconnect. To reconnect, return the iPhone to the cradle.

- **Bluetooth Undocked mode** – iFusion operates whenever the iPhone enters the iPhone's Bluetooth range. In other words, the iPhone does not have to be docked in the iFusion cradle in order to work.

Start this mode by leaving the iPhone out of the cradle while you pair the two devices.

When you enter the iFusion Bluetooth range while on a voice call, the call's audio will remain on your iPhone. If you enter the Bluetooth range while listening to music or to a voicemail message, the audio will automatically switch to the iFusion.

For full details on these modes, refer to the *iFusion User Manual*.

Pairing the iPhone with the iFusion

1. Prepare the iPhone

Place your iPhone in the cradle (for Bluetooth Docked mode).

On your iPhone, tap *Settings* > *General* > *Bluetooth*. Turn Bluetooth on.

The iPhone is now discoverable, and it searches for other Bluetooth devices nearby.



4290-0024 Rev E

2. Prepare the iFusion

Touch and hold the Bluetooth button on the iFusion for three to five seconds, until the Bluetooth button blinks rapidly and beeps twice. The iFusion is now in pairing mode.

3. Pair the iPhone and the iFusion

Once the iFusion is listed as a device on the iPhone, tap *iFusion xxxxxx* to pair and connect the two devices.

On the iPhone, the status changes from *Not Paired* to *Connected* once the pairing process has been completed.



Basic operations

Making and answering calls

You can call a number from your iPhone's Contacts list, Call log, dial pad, or Favorites list.

If the iPhone is docked when you make a call, the iFusion speaker automatically comes on unless you pick up the handset.

When a call comes in, both the iPhone and the iFusion ring. To answer the call, either pick up the handset or touch the Speaker button on the iFusion.

To end a call, touch the Speaker button on the iFusion (if you were on speaker) or return the handset to its cradle.

Switching iFusion calls to the iPhone

You can switch a call from the iFusion to the iPhone, and vice versa.

In Bluetooth Docked mode, just remove the iPhone from the cradle to switch the call to the iPhone.

In Bluetooth Undocked mode, remove the iPhone from the cradle (if it is docked). Then tap the iPhone *audio source* button and tap *iPhone*.

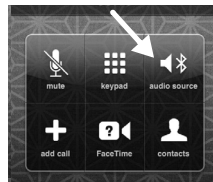

Adjusting the volume



The Volume buttons adjust four different sound levels:

1. Ringer – If a call is coming in (or if the iFusion is idle), the Volume buttons adjust the sound level of the iFusion ringer.

2. Speaker – If you are on a call through the speaker, the Volume buttons adjust the sound level of the speaker.

3. Handset – If you are on a call on the handset, the Volume buttons adjust the sound level of the handset.

4. Music – If you are playing music, the Volume buttons adjust the sound level of the music.

The Volume buttons will blink rapidly when the volume reaches the minimum or maximum level.

If power to the iFusion is interrupted, all volume levels will return to their default settings.

To mute the ringer on the iFusion, touch the Volume Down button until it blinks rapidly. (This will not mute the iPhone ringer.)

Pressing an iPhone Volume button will mute both the iPhone ringer and the iFusion ringer for the current call.

Playing music

Tap the *iPod* icon on your iPhone to play songs through the iFusion speaker.

To play music through external speakers, connect them to the audio jack in the back of the iFusion.

If a call comes in while you are playing music, the music stops automatically. When you end the call, the music automatically resumes.

iFusion buttons



Bluetooth – Touch and hold (for 5 seconds) to enter pairing mode.

Rapid blinking: Pairing

Slow blinking: Reconnecting

Solid light: Connected



Mute – Mutes the handset or speaker. Touch again to unmute the call. Red light: Muted



Speaker – Moves the audio to the speaker. Green light: Hands-free mode (speaker is enabled)



Volume Down – Lowers the volume. Rapid blinking: Minimum reached



Volume Up – Raises the volume. Rapid blinking: Maximum reached