

Coolport

Outlets for sharing devices over one 4 pair cable



The revolutionary new Coolport is a 3 port outlet that enables you to connect up to 3 different devices (such as PC, Telephone or Fax) to one 4 pair cable. All 3 devices are then continuously available.

Easily mounted onto a desk or wall, Coolports are supplied in pairs, with one connected to a wall outlet and the other to a patch panel, using launch leads.

Coolports therefore, provide an instant method for adding more devices to a single cable port - ideal in emergency situations where not enough network outlets are available, or when the cost or disruption caused by installing additional cabling is prohibitive. Four different Coolport types are available:

Colour	Description
Purple	2 x 10/100Base T (Ethernet)
Red	1 x 10/100Base T + 2Pr Voice (Analogue)
Blue	1 x 10/100Base T + 2 x 1Pr Voice (Digital)
Amber	3 x 1Pr Voice (Digital)

Features:

- Maximize the number of devices available using existing 4 pair cabling system
- Operate up to 3 services per single 4 pair cable
- Enables rapid equipment deployment in disaster recovery situations
- Reduces disruption during network expansion
- Provides added capacity in difficult to cable buildings
- Plug and play installation (Jack to Jack patch leads)
- IDC blocks suitable for permanent installation alternative

Technical Description:

Many services used over Category 5 cable only require two pairs. Because Cat 5 cable contains 4 pairs, two pairs may not therefore be currently utilised.

Coolport transposes the pairs used by two to three services enabling these spare pairs to be utilised. To enable the conversion back at the comms room or cabinet another Coolport is required. Alternatively, in situations incorporating a number of Coolports, a Coolport patch panel is recommended.

Four types of Coolport are available, depending on the services required (see back). Two or three of the RJ45 jacks located at the front of the Coolport connect to the user equipment, while the single jack located at the back connects to the Category 5 cable or wall outlet.

Another Coolport is then used to convert the cable back for connection to a standard 19" patch panel located in either a telecommunication closet or computer equipment room.

Each Coolport features high quality components. The case is made from rugged translucent ABS plastic, the PCB boards are specially designed by HellermannTyton, and the RJ45 jacks used are of the highest quality construction. Completely assembled by HellermannTyton, every Coolport is also performance tested at our factory and is backed by our lifetime manufacturer guarantee.

Choose the Coolport set that will best suit your requirements.

It's important to remember that in every installation, at least two Coolports are required - one at the desk area, for connection to the nearest wall outlet, and another within the comms room, for connection to the nearest wall outlet, and another within the comms room, (or communications equipment cabinet) for connection to a 19" patch panel.

Installation is plug-and-play, as all connections are made using RJ45 jacks and plugs. For more permanent fixing to either a wall or desk, self adhesive pads are included, and screw fixing slots are also located at the base of each Coolport.

There are four different Coolport variations available - each coloured differently to enable users to quickly identify the services which can be connected (see services schematics to the right).

- Comms Room**
- Desk Area**

Coolports are available in pairs - two Coolports and two adhesive pads. Launch leads and patch cords can be purchased separately.

Coolport Kits:

The Coolport outlets are also available in 'Kit' form (pre-packed with two 6" launch leads, two 2m patch cords, plus two adhesive fixing pads).

Their order codes are as follows:

- Purple Kit Code: CP2/2DA KIT
- Red Kit Code: CP2/1DA/1AV KIT
- Blue Kit Code: CP3/1DA/1AV Kit
- Yellow Kit Code: CP3/3DV Kit

Coolport Dimensions:

- Length = 70mm
- Width = 60mm
- Height = 40mm
- Weight = 5.5g (approx.)

* Only one pair working (Pins 4 & 5)

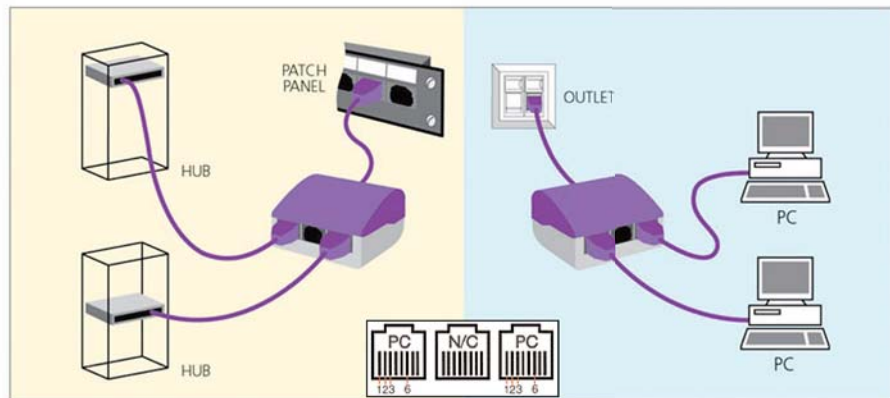

Product: Purple Coolport Set **Code:** CP2/2DA **Description:** Two 10/100 Base T Data

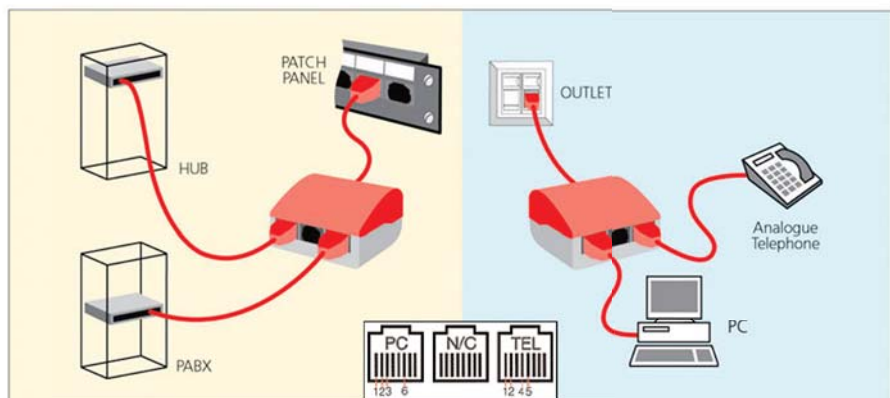

Product: Red Coolport Set **Code:** CP2/1DA/1AV **Description:** One Data and One Analogue Voice

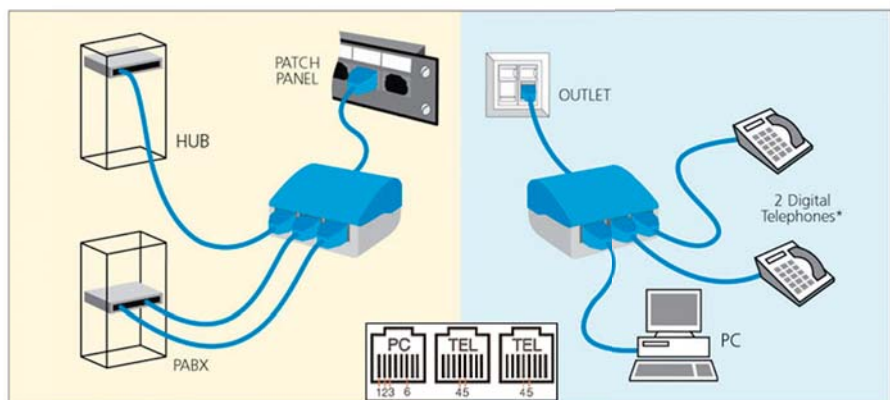

Product: Blue Coolport Set **Code:** CP3/1DA/2DV **Description:** One Data and Two Digital Voice

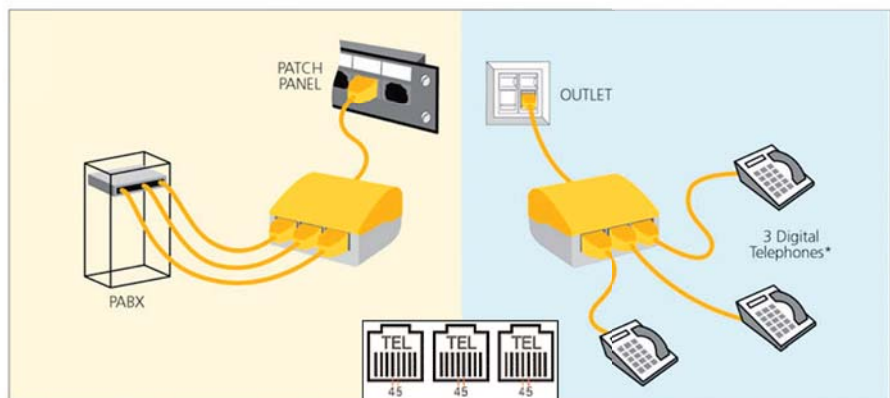

Product: Amber Coolport Set **Code:** CP3/3DV **Description:** Three Digital Voice